

Box: PLOCK 1

BIKE	KAWASAKI ZX6	PART NO.	KA-1001
YEAR	2009 - 2010	FIT KITS	ROUND Z039.10392
NOTES		FEATURES	N/A

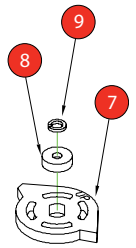
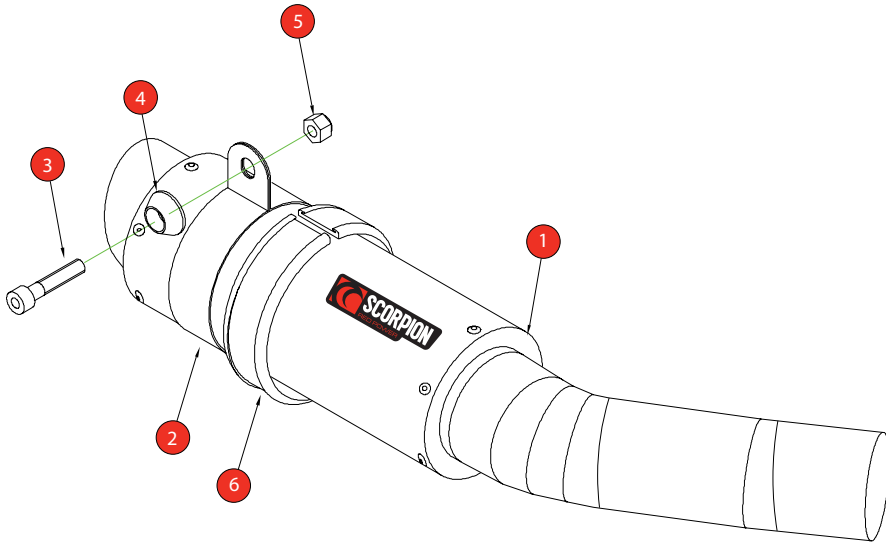

- 1 225mm RP-1 GP silencer SC160 with intergrated CP 583
- 2 Titanium Silencer Strap (Z028.10013)
- 3 M8 x 40mm Cap Head Bolt (Z017.10076)
- 4 1 of Bolt Finisher (Z026.20068)
- 5 M8 Nyloc nut (Z017.10062)
- 6 Square edge rubber (Z029.10024)
- 7 Servo wheel (Z007.10955)

- 8 Aluminium collar (Z026.20045)
- 9 M6 split washer (Z017.10027)

E-MARK	KA85 e4 2359 9
ISSUE NO.	2
DATE	15/11/11
AUTHORISED	S.PEPPER
CHECKED	

**NOTE:** ENSURE SCORPION SYSTEM IS CLEAR OF MOVING PARTS AND ALL ORIGINAL FUNCTIONS WORK CORRECTLY.



- A) Remove original exhaust from bike, taking care to keep all original components in a safe place.
- B) Refit Scorpion exhaust as per line diagram above.
- C) when fitted take bike for a short ride to ensure all functions are correct.
- D) when bike & exhaust are cool enough check all nuts and bolts are still secure.



Box: PLOCK 1

BIKE	KAWASAKI ZX6	PART NO.	KA-1001
YEAR	2009 - 2010	FIT KITS	ROUND Z039.10392
NOTES		FEATURES	N/A

CONTINUED FROM OVERLEAF:



A) Disconnect cables on exhaust valve and leave loose..

B) To disconnect cables at the servo box end, you have to remove the hexagonal wheel, without turning it's shaft.

Remove bolt in centre of hexagonal wheel using an 8mm socket. Support wheel if tight.

C) Remove hexagonal wheel from shaft, retaining OE bolt. DO NOT turn shaft.

Remove spring clip retaining cables and completely remove the cables



D) The replacement wheel comes with an aluminium collar & spring washer that is secured in place with OE bolt - TIGHTEN TO 5ft/lb USING A TORQUE WRENCH.

The replacement wheel must be fitted with the etched letters "UP"

E IS RIGHT!

F IS WRONG!

